

# NEOZED D0 fuse-links gG 400/440VAC

LOW VOLTAGE IEC FUSES

DIN LV FUSE-LINKS D0



The D0 fuse-system is installed in low voltage distribution units, where fuse-links are accessible to non trained persons and can also be replaced by them.

The system is the most modern of the screw systems and designed for 400VAC/250VDC networks.

The D0 fuse range comprises the standardized fuse sizes D01, D02 and D03.

The range of applications for D0 fuse-links for general application is the protection of cables and power lines. They limit and cut off unacceptable overcurrents and short circuit currents up to their nominal breaking capacity. D0 fuse-links “gG” also protect equipments and installations against dynamic effects of high short circuit currents.

## TECHNICAL DATA OVERVIEW

Voltage Range AC	400 ... 440 VAC
Voltage DC	250 VDC
Ampere Range (A)	2 ... 100 A
Speed/Characteristic	gG
Product Size	D01 to D03

## FEATURES & BENEFITS

- Insulated body suitable for high mechanical and thermal impacts
- Top and bottom contacts made of nickel plated or silver plated copper alloy
- Safe cut-off short circuits and over currents due to special design of fuse element
- Clear indication of operation condition due to coloured indicator un top contact
- Low power dissipation
- Optimized size
- Resistant to aging

## APPLICATIONS

- House incoming units
- Meter distribution units
- Distribution cabinets
- Installation cabinets
- Fuse boxes

## STANDARDS

- DIN VDE 0636-3



# NEOZED DO fuse-links gG 400/440VAC

## PRODUCT RANGE



D01GG40V2

### Size D01 (E14) gG

Catalog number	Item number	Rated voltage AC (IEC)	Rated voltage DC (IEC)	Rated current I <sub>n</sub>	Colour	Power dissipation at I <sub>n</sub>	Utilisation category	Weight	Package
D01GG40V2	T214676	400 V	250 V	2 A	pink	1.5 W	gG	6.6 g	50
D01GG40V4	W200809	400 V	250 V	4 A	brown	1.5 W	gG	6.6 g	50
D01GG40V6	B215695	400 V	250 V	6 A	green	1.3 W	gG	6.6 g	50
D01GG40V10	W211090	400 V	250 V	10 A	red	1.8 W	gG	6.6 g	50
D01GG40V13	C201206	400 V	250 V	13 A	black	-	gG	6.6 g	50
D01GG40V16	R223023	400 V	250 V	16 A	grey	2.1 W	gG	6.6 g	50



D02GG40V20

### Size D02 (E18) gG

Catalog number	Item number	Rated voltage AC (IEC)	Rated voltage DC (IEC)	Rated current I <sub>n</sub>	Colour	Power dissipation at I <sub>n</sub>	Utilisation category	Weight	Package
D02GG40V20	B217742	400 V	250 V	20 A	blue	2.3 W	gG	12 g	50
D02GG40V25	W213160	400 V	250 V	25 A	yellow	2.6 W	gG	12 g	50
D02GG40V32	S227647	400 V	250 V	32 A	black	-	gG	12 g	50
D02GG40V35	R219826	400 V	250 V	35 A	black	2.9 W	gG	12 g	50
D02GG40V40	Q1028666	400 V	250 V	40 A	black	2.9 W	gG	12 g	50
D02GG40V50	D215191	400 V	250 V	50 A	white	3.5 W	gG	12 g	50
D02GG40V63	C201873	400 V	250 V	63 A	copper	4.2 W	gG	12 g	50



D03GG40V100

### Size D03 (M30x2) gG

Catalog number	Item number	Rated voltage AC (IEC)	Rated voltage DC (IEC)	Rated current I <sub>n</sub>	Colour	Power dissipation at I <sub>n</sub>	Utilisation category	Weight	Package
D03GG40V80	L216716	400 V	250 V	80 A	silver	4.9 W	gG	41 g	10
D03GG40V100	N212647	400 V	250 V	100 A	red	5.2 W	gG	41 g	10



D01GG44V2

### Size D01 (E14) gG Marine

Catalog number	Item number	Rated voltage AC (IEC)	Rated voltage DC (IEC)	Rated current I <sub>n</sub>	Colour	Power dissipation at I <sub>n</sub>	Utilisation category	Weight	Package
D01GG44V2	E218780	440 V	250 V	2 A	pink	1.5 W	gG	6.6 g	50
D01GG44V4	V219829	440 V	250 V	4 A	brown	1.5 W	gG	6.6 g	50
D01GG44V6	X223028	440 V	250 V	6 A	green	1.3 W	gG	6.6 g	50
D01GG44V10	S201358	440 V	250 V	10 A	red	1.8 W	gG	6.6 g	50
D01GG44V16	C211096	440 V	250 V	16 A	grey	-	gG	6.6 g	50



D02GG44V25

### Size D02 (E18) gG Marine

Catalog number	Item number	Rated voltage AC (IEC)	Rated voltage DC (IEC)	Rated current I <sub>n</sub>	Colour	Power dissipation at I <sub>n</sub>	Utilisation category	Weight	Package
D02GG44V20	X212126	440 V	250 V	20 A	blue	2.1 W	gG	12.6 g	50
D02GG44V25	S213663	440 V	250 V	25 A	yellow	2.3 W	gG	12.6 g	50
D02GG44V35	C214684	440 V	250 V	35 A	black	2.9 W	gG	12.6 g	50
D02GG44V50	J215702	440 V	250 V	50 A	white	3.5 W	gG	12.6 g	50
D02GG44V63	N216718	440 V	250 V	63 A	copper	4.2 W	gG	12.6 g	50

# NEOZED D0 fuse-links gG 400/440VAC

## TIME CURRENT CHARACTERISTIC CURVES

NEOZED D0 fuse-links gG 400/440VAC

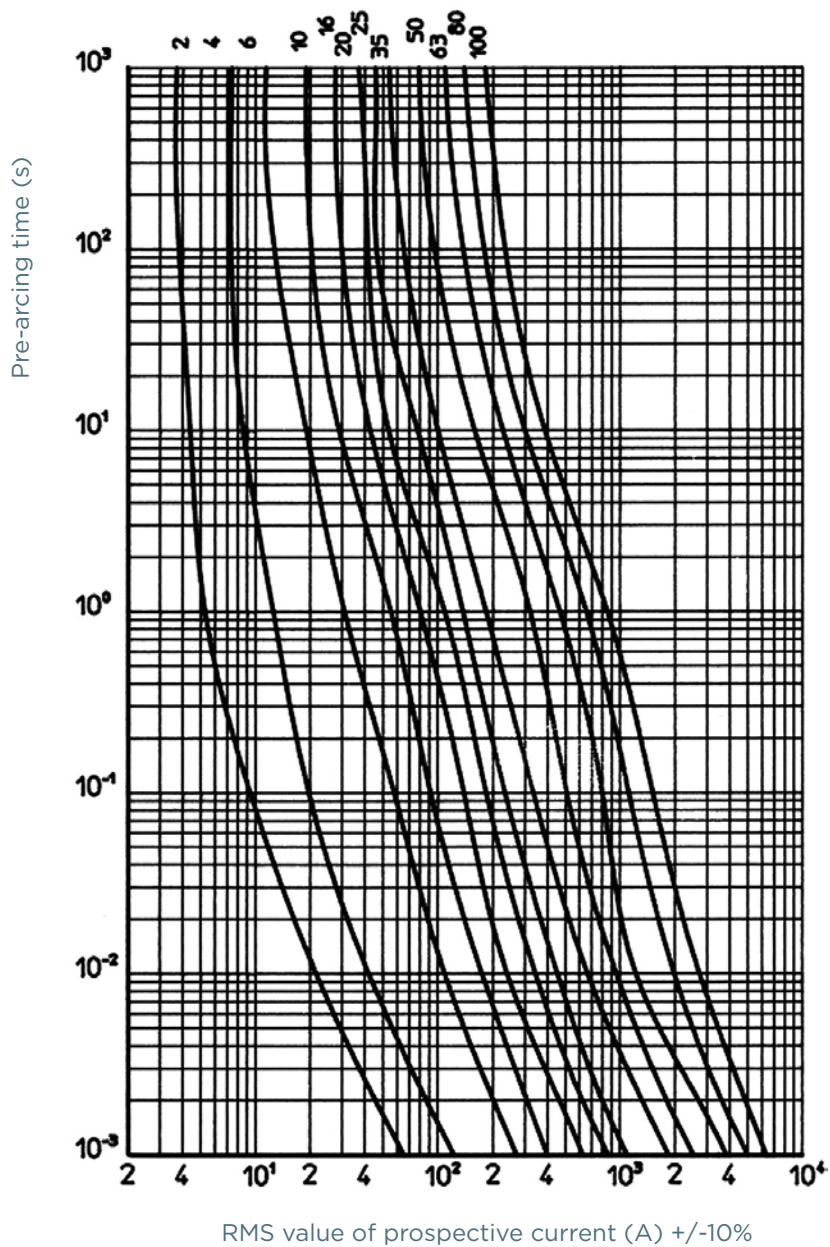

MERSEN reserves the right to change, update or correct, without notice, any information contained in this datasheet.

# NEOZED D0 fuse-links gG 400/440VAC

## CUT-OFF CURRENT CHARACTERISTIC

NEOZED D0 fuse-links gG 400/440VAC

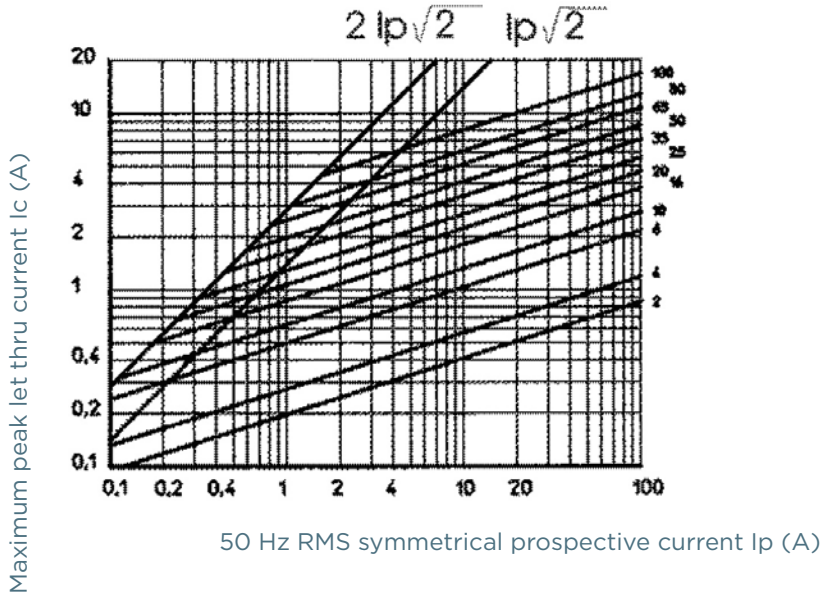

## DIMENSIONS

### NEOZED Fuse-Links

Size	a	b
D01	36 mm	11 mm
D02	36 mm	15 mm
D03	43 mm	22 mm

Dimensions in mm

### NEOZED Screw Caps

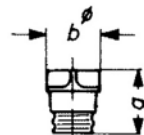

Article Number	a	b
01714.000000	29,5	23
01715.000000	29,5	23
01710.000000	31	25
01711.000000	31	25
01712.000000	37	40

Dimensions in mm

### NEOZED Adapter Inserts

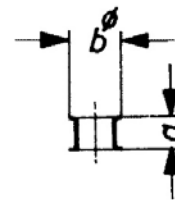

Article Number	a	b
01705.000000	10	12
01706.000000	10	16
01707.000000	10	27

Dimensions in mm

# NEOZED D0 fuse-links gG 400/440VAC

## ACCESSORIES



01714.000200



01715.000200



11714.000220



11715.000220



01715.000000

### D0 screw caps 400V AC synthetic

Catalog number	Item number	Weight	Description	Weight	Package
01714.000200	E212501	12 g	D01, E14, 16A, with testing hole	11.8 g	20
01715.000200	P211981	12.6 g	D02, E18, 63A, with testing hole	11.6 g	20
11714.000220	R214536	12.1 g	D01, E14, 16A, with sealing and testing hole	11.6 g	20
11715.000220	S214537	12.4 g	D02, E18, 63A, with sealing and testing hole	11.6 g	20
01715.000000	L206435	12.7 g	D02, E18, 63A, without testing hole	12 g	20
01715.890200	M214026	13.5 g	D02, E18, 63A, with adapter insert for fuse links size D01	12.4 g	20



01711.000200



01770.000200

### D0 screw caps 400/440 VAC, 250 V DC porcelain, with removal grips

Catalog number	Item number	Weight	Description	Weight	Package
01710.000200	H201211	-	D01, E14, 16A, with testing hole	16.4 g	20
01711.000200	T215044	18.6 g	D02, E18, 63A, with testing hole	18.5 g	20
01712.000200	V215045	87.9 g	D03, M30x2, 100A, with testing hole	84 g	10
01770.000200	F1033740	16.8 g	D01, E14, 16A, with testing hole	16.4 g	20



01705.002000



01705.004000

### D0 cartridge ring adapter inserts D01 E14

Catalog number	Item number	Weight	Description	Weight	Package
01705.002000	J216576	0.5 g	2A, pink	0.4 g	50
01705.004000	J219681	0.5 g	4A, brown	0.4 g	50
01705.006000	P206438	0.5 g	6A, green	0.4 g	50
01705.010000	M213014	0.5 g	10A, red	0.4 g	50



01705.006000



01705.010000

MERSEN reserves the right to change, update or correct, without notice, any information contained in this datasheet.

# NEOZED D0 fuse-links gG 400/440VAC

## ACCESSORIES

### D0 cartridge ring adapter inserts D02 E18



01706.020000



01706.025000



01706.035000



01706.050000



01706.002000



01706.004000



01706.006000



01706.010000



01706.016000

Catalog number	Item number	Weight	Description	Application	Weight	Package
01706.020000	S200668	0.8 g	20A, blue	-	0.5 g	50
01706.025000	R213524	0.7 g	25A, yellow	-	0.6 g	50
01706.035000	J216070	0.7 g	35A, black	-	0.5 g	50
01706.050000	R218630	0.7 g	50A, white	-	0.7 g	50
01706.002000	K216577	0.8 g	2A, pink	For D01 fuse links in D02 fuse bases	0.5 g	50
01706.004000	S222127	0.8 g	4A, brown	For D01 fuse links in D02 fuse bases	0.6 g	50
01706.006000	R211983	0.8 g	6A, green	For D01 fuse links in D02 fuse bases	0.6 g	50
01706.010000	H216069	0.8 g	10A, red	For D01 fuse links in D02 fuse bases	0.6 g	50
01706.016000	Q218629	0.8 g	16A, grey	For D01 fuse links in D02 fuse bases	0.5 g	50



01707.080000

### D0 cartridge ring adapter inserts D03 M30x2

Catalog number	Item number	Weight	Description	Weight	Package
01707.080000	T200669	1.5 g	80A, silver	1.6 g	20

MERSEN reserves the right to change, update or correct, without notice, any information contained in this datasheet.

# NEOZED D0 fuse-links gG 400/440VAC

## ACCESSORIES



01714.800000



01714.830000

### Locking devices

Catalog number	Item number	Weight	Description	Weight	Package
01715.800000	R214582	38 g	Locking cap for D02 E18 fuse-bases for authorized personal only (EVU)	14 g	5
01715.810000	Y215094	16.6 g	Locking cap for D02 E18 fuse-bases	13.7 g	5
01714.800000	D212546	36 g	Locking cap for D01 E14 fuse-bases for authorized personal only (EVU)	12.2 g	5
01714.810000	P213062	36 g	Locking cap for D01 E14 fuse-bases	12.4 g	5
01714.830000	J214069	45 g	Special key for locking caps	32.9 g	1



01707.000000



01713.000000

### Adapter inserts

Catalog number	Item number	Weight	Description	Weight	Package
01707.000000	T211985	16.9 g	Adapter (space holder) for Size D02 fuse-links in Size D03 bases	17.4 g	30
01709.000000	P214028	1.7 g	Adapter for Size D02 fuse-links in Size D03 bases	1.3 g	25
01713.000000	Z215049	1.2 g	Adapter for Size D01 fuse-links in Size D02 bases	0.9 g	50
01733.000000	J218117	1 g	Adapter for Size D01 fuse-links in DL-bases	0.2 g	100